



Texture Garden with Winter Appeal
view from the street



view from the home



planting plan





planting diagram

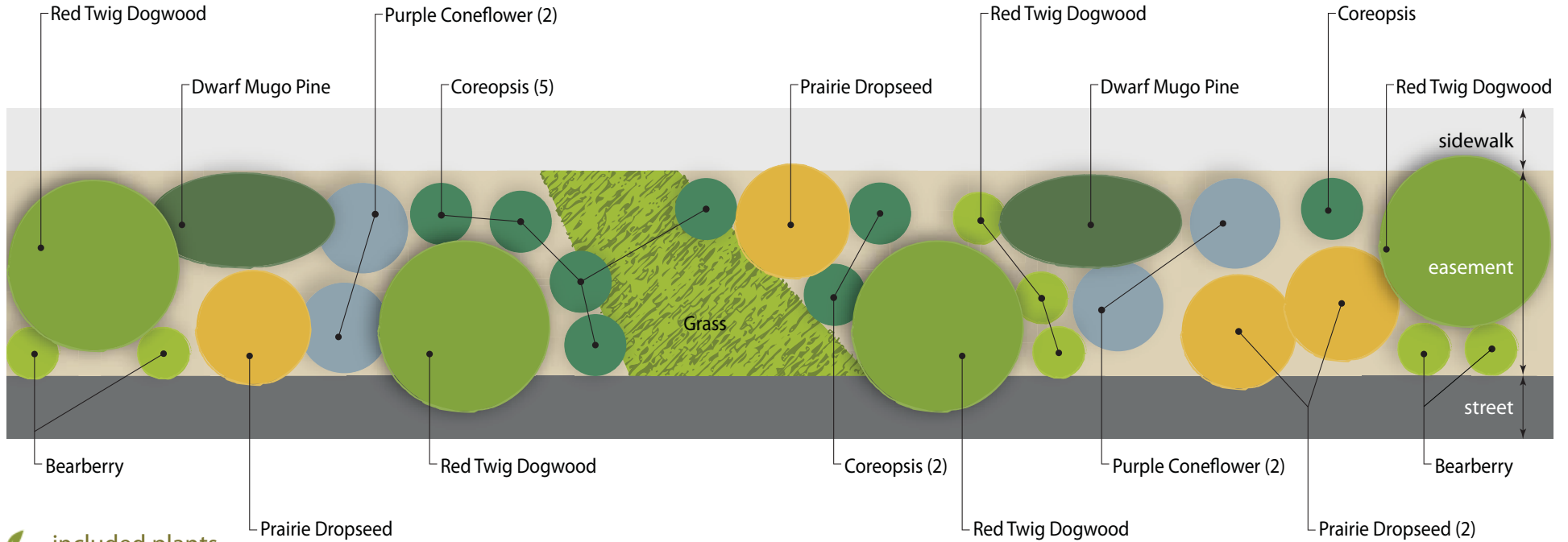

included plants



plant list

Type	Common Name	Latin Name	How Many	Size & Condition	Remarks	Salt Tolerant	Aesthetic Tolerant	Ecological Traits
Shrubs	Mugo Pine	<i>Pinus mugo</i>	2	12" BB	As on plan	Yes	Low growing evergreen shrub	
	Red Twig Dogwood	<i>Cornus sericea</i>	4	3 gal.	As on plan	Yes	Bright green leaves in summer and bright red twigs show in winter	Attracts birds and butterflies
Perennials	Purple Coneflower	<i>Echinacea purpurea</i>	4	1 gal.	2' o.c.	Yes	Long lasting pink-orange flowers throughout the summer	Attracts butterflies & hummingbirds
	Threadleaf Coreopsis	<i>Coreopsis verticillata</i>	8	1 gal.	2' o.c.	Yes	Fine textured plant with bright yellow summer flowers	Attracts butterflies
Ornamental Grasses	Prairie Dropseed Grass	<i>Sporobolus heterolepis</i>	4	1 gal.	2' o.c.	Yes	Clump forming grass with graceful arching flowers and leaves	Attracts birds
Groundcovers	Bearberry	<i>Arctostaphylos uva-ursi</i> 'Massachusetts'	7	1 gal.	2' o.c.	Yes	Evergreen groundcover with small pink flowers & bright red berries	Attracts birds
				BB = balled & burlapped gal. = gallon container	o.c. = on center spacing			